

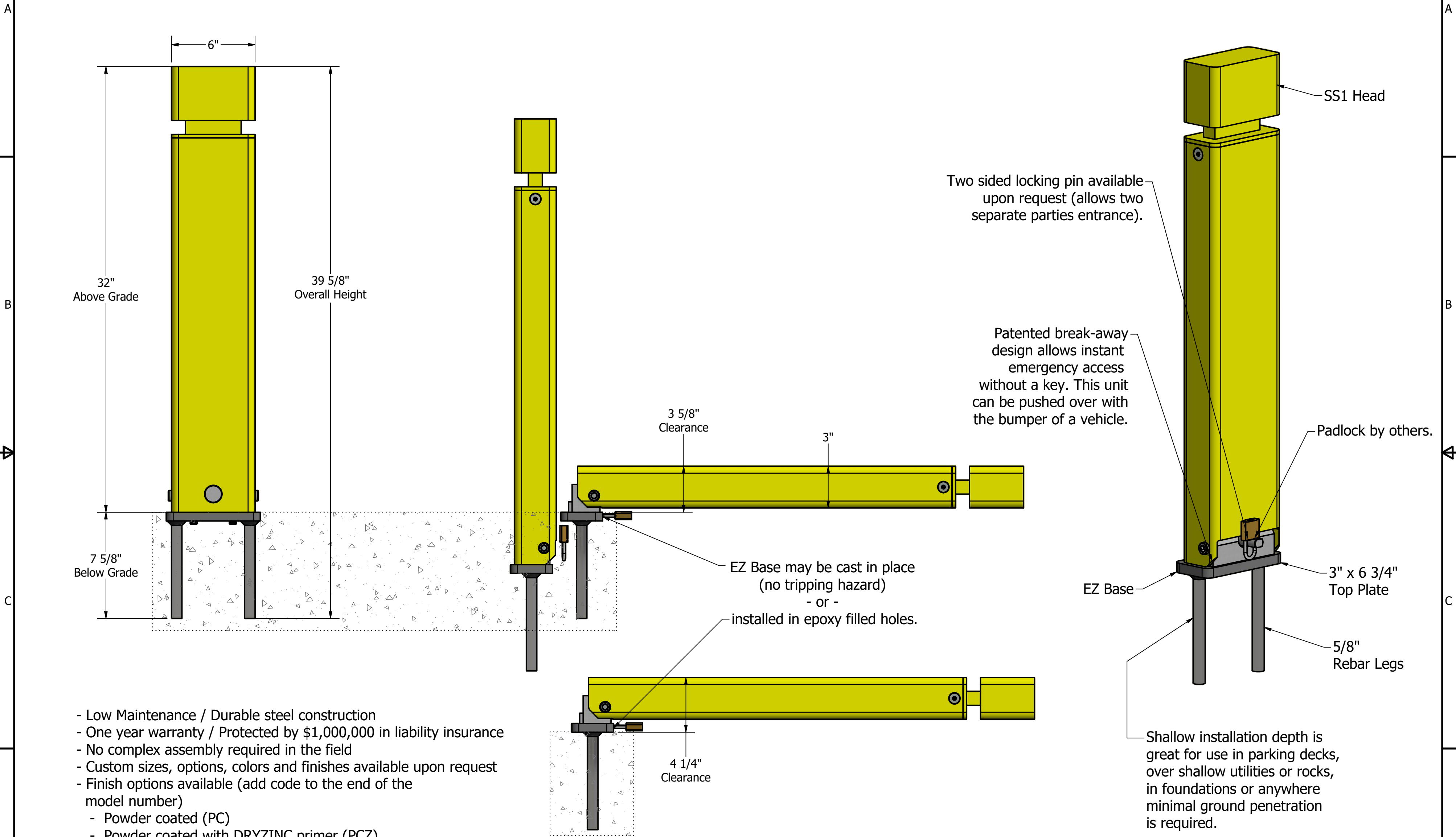

MaxiForce Collapsible Bollard

Standard Body, Padlock Operated, Standard Style 1 Head, EZ Base

AHJ approved in many cities / counties / campuses for use in fire lanes per International Fire Code (IFC) 503



- Low Maintenance / Durable steel construction
- One year warranty / Protected by \$1,000,000 in liability insurance
- No complex assembly required in the field
- Custom sizes, options, colors and finishes available upon request
- Finish options available (add code to the end of the model number)
 - Powder coated (PC)
 - Powder coated with DRYZINC primer (PCZ)
 - Hot dip galvanized (G)
 - Hot dip galvanized & powder coated (GPC)
- Reflective tape available upon request

Bollard Assy. Weight	Base Weight
45 lbs	5 lbs
Drawing Rev.	Created
2	11/26/2020
PROPRIETARY AND CONFIDENTIAL	
THIS DRAWING CONTAINS PROPRIETARY INFORMATION OF BLUE EMBER TECHNOLOGIES, LLC. ANY USE OF THIS DRAWING OR THE INFORMATION CONTAINED HEREIN FOR OTHER THAN THE PURPOSE FOR WHICH THIS DRAWING IS FURNISHED IS FORBIDDEN.	

MaxiForce
7560 Main Street
Sykesville, MD 21784
tel: +1 (410) 552 9888
sales@maxiforcebollards.com
www.maxiforcebollards.com



MCSP-SS1-EZ